

# ZERO<sup>®</sup>—PRICE LIST

## EXPORT-Outdoor

Excl VAT

Valid 2024-01-01 - 2024-07-31

---

Zero, Friluftsvagen 2, 382 34 Nybro, Sweden  
Tel: +46 (0) 481 800 00  
info@zero.se www.zero.se



## A.01

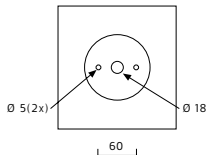
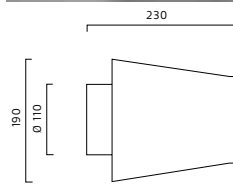
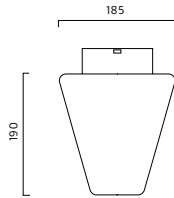

**Finish:** White- or grey painted galvanized steel or corten finish. Cover in matt acrylic. Coast line model in galvanized steel

**Installation:** Wall installation.

**Connection:** Terminal-block 3x4mm<sup>2</sup>. Distance-piece for external mains cable available as accessory.

**Design:** Kjellander + Sjöberg.

| ART                       | DESCRIPTION                      |                          | PRICE/EUR |
|---------------------------|----------------------------------|--------------------------|-----------|
| <b>Up &amp; downlight</b> |                                  |                          |           |
| 3049110                   | A.01 wall fixture outdoor grey   | IP44 LED 747LM/10W/3000K | 698,37    |
| 3049147                   | A.01 wall fixture outdoor Corten | IP44 LED 747LM/10W/3000K | 677,95    |
| 3049183                   | A.01 wall outdoor galv           | IP44 LED 747LM/10W/3000K | 724,72    |
| 3051110                   | A.01 wall fixture outdoor grey   | IP44 75W/E27             | 470,94    |
| 3051147                   | A.01 wall fixture outdoor corten | IP44 75W/E27             | 513,06    |
| 3051183                   | A.01 wall fixture outdoor galv   | IP44 75W/E27             | 497,69    |
| <b>Downlight only</b>     |                                  |                          |           |
| 12040110-30               | A.01 wall fixture outdoor grey   | IP44 LED 457LM/10W/3000K | 752,75    |
| 12040147-30               | A.01 wall fixture outdoor corten | IP44 LED 457LM/10W/3000K | 729,87    |
| 12040183-30               | A.01 wall fixture outdoor galv   | IP44 LED 457LM/10W/3000K | 779,10    |
| 12041110                  | A.01 wall fixture outdoor grey   | IP44 75W/E27             | 525,82    |
| 12041147                  | A.01 wall fixture outdoor corten | IP44 75W/E27             | 519,87    |
| 12041183                  | A.01 wall fixture outdoor galv   | IP44 75W/E27             | 497,43    |
| <b>ACCESSORIES</b>        |                                  |                          |           |
| 93040110                  | A.01 Distance piece grey         | for external mains cable | 48,84     |

## ALLRIGHT

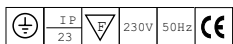
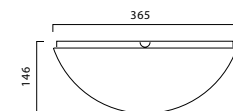
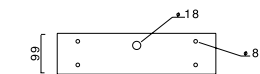
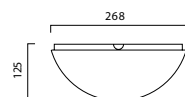

**Finish:** Anodized aluminium, natural, bronze or dark grey painted and white painted steel. Diffuser in prismatic acrylic.

**Installation:** On wall.

**Connection:** Snap-in terminal block 3x4mm<sup>2</sup>. 7417-terminal block 5x4mm<sup>2</sup>.

**Design:** Per Sundstedt.

| ART        | DESCRIPTION                    |                               | PRICE/EUR |
|------------|--------------------------------|-------------------------------|-----------|
| 7426138    | ALLRIGHT wallamp aluminium     | IP23 LED/10W/576LM/3000K B268 | 523,01    |
| 7426138-40 | ALLRIGHT wallamp aluminium     | IP23 LED/10W/634LM/4000K B268 | 539,44    |
| 7426147    | ALLRIGHT wallamp Corten        | IP23 LED/10W/576LM/3000K B268 | 523,32    |
| 7426147-40 | ALLRIGHT wallamp corten        | IP23 LED/10W/634LM/4000K B268 | 539,67    |
| 7426183    | ALLRIGHT wall fixture galv     | IP23 LED/10W/576LM/3000K B268 | 529,50    |
| 7426183-40 | ALLRIGHT wall fixture galv     | IP23 LED/10W/634LM/4000K B268 | 546,06    |
| 7426197    | ALLRIGHT wallamp bronze        | IP23 LED/10W/576LM/3000K B268 | 528,50    |
| 7426197-40 | ALLRIGHT wallamp bronze        | IP23 LED/10W/634LM/4000K B268 | 560,96    |
| 7426198    | ALLRIGHT wallamp dark grey     | IP23 LED/10W/576LM/3000K B268 | 544,41    |
| 7426198-40 | ALLRIGHT wallamp dark grey     | IP23 LED/10W/634LM/4000K B268 | 560,96    |
| 7426338    | ALLRIGHT wall fixture alum     | IP23 LED/10W/585LM/3000K B365 | 653,68    |
| 7426338-40 | ALLRIGHT wall fixture alum     | IP23 LED/10W/644LM/4000K B365 | 670,24    |
| 7426347    | ALLRIGHT wall fixture corten   | IP23 LED/10W/585LM/3000K B365 | 661,99    |
| 7426347-40 | ALLRIGHT wall fixture corten   | IP23 LED/10W/644LM/4000K B365 | 678,33    |
| 7426383    | ALLRIGHT wall fixture galv     | IP23 LED/10W/585LM/3000K B365 | 674,44    |
| 7426383-40 | ALLRIGHT wall fixture galv     | IP23 LED/10W/644LM/4000K B365 | 690,99    |
| 7426397    | ALLRIGHT wall fixtures bronze  | IP23 LED/10W/585LM/3000K B365 | 676,98    |
| 7426397-40 | ALLRIGHT wall fixtures bronze  | IP23 LED/10W/644LM/4000K B365 | 693,54    |
| 7426398    | ALLRIGHT wall fixtures grey    | IP23 LED/10W/585LM/3000K B365 | 676,98    |
| 7426398-40 | ALLRIGHT wall fixtures grey    | IP23 LED/10W/644LM/4000K B365 | 693,54    |
| 7427338    | ALLRIGHT wall fixture alum     | IP23 LED/10W/585LM/3000K B365 | 783,48    |
| 7427338-40 | ALLRIGHT wall fixture alum     | IP23 LED/10W/585LM/3000K B365 | 799,44    |
| 7427347    | ALLRIGHT wall fixture corten   | IP23 LED/10W/585LM/3000K B365 | 821,94    |
| 7427347-40 | ALLRIGHT wall fixture corten   | IP23 LED/10W/644LM/4000K B365 | 837,91    |
| 7427383    | ALLRIGHT wall galv with socket | IP23 LED/10W/585LM/3000K B365 | 803,28    |
| 7427383-40 | ALLRIGHT wall galv with socket | IP23 LED/10W/644LM/4000K B365 | 819,24    |
| 7427397    | ALLRIGHT wall fixtures bronze  | IP23 LED/10W/585LM/3000K B365 | 803,28    |
| 7427397-40 | ALLRIGHT wall fixtures bronze  | IP23 LED/10W/644LM/4000K B365 | 819,24    |
| 7427398    | ALLRIGHT wall fixtures grey    | IP23 LED/10W/585LM/3000K B365 | 803,28    |

## BRASS

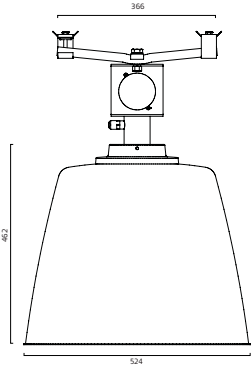

**Finish:** Painted metal, pearl gold (RAL 1036). Shade in transparent acrylic. Brass net and opal acrylic diffuser.

**LED info:** Luminaire Luminous Flux 1800LM System power 32W CCT 3000K. SDCM 3. CRI >80

**Installation:** On wire.

**Connection:** Double conduit entry.

| ART        | DESCRIPTION          |                         | PRICE/EUR |
|------------|----------------------|-------------------------|-----------|
| 3436180-30 | BRASS catenary brass | IP54 LED 1800LM/32W     | 3 238,33  |
| 3436180D30 | BRASS catenary brass | IP54 LED 1800LM/32W dim | 3 328,86  |

D = Dimmable DALI.

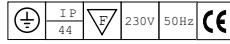

## BRASS

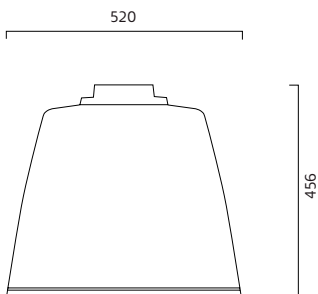

**Finish:** Painted metal, pearl gold (RAL 1036). Shade in transparent acrylic. Brass net and opal acrylic diffuser.

**LED info:** Luminaire Luminous Flux 2240LM System power 28W CCT 3000K. SDCM 3. CRI >80

**Installation:** On pole D60mm.

**Connection:** Cable and quick-plug.

Including Philips True Force LED light source.

| ART     | DESCRIPTION              |                     | PRICE/EUR |
|---------|--------------------------|---------------------|-----------|
| 3431180 | BRASS post fixture brass | IP54 LED 28W/2240LM | 2 481,74  |

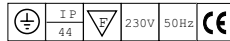

## CAMOUFLAGE



**Finish:** Laser-cut raw aluminium. The surface is raw - one can see scratches and other marks.  
 Can be painted in polyester color on request.  
**Installation:** Wire pendant. Special lengths on request.  
**Connection:** 3 m rubber cable without plug.  
**Design:** Front 2007.

| ART     | DESCRIPTION                 |                    | PRICE/EUR |
|---------|-----------------------------|--------------------|-----------|
| 3328385 | CAMOUFLAGE wire pendant alu | IP44 E27 max 42W   | 3 538,19  |
| 3329385 | CAMOUFLAGE wire pendant alu | IP44 LED 10W 3000K | 3 771,87  |

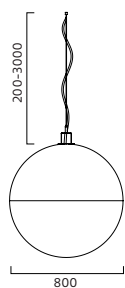

## CITY



**Finish:** Painted aluminum, black (RAL 9005) or beige grey (RAL 7006) as standard. Other colours on request.  
Internal shade in white painted aluminum. Can be completed with internal matt glass diffuser. Can be made without grid on request.

**LED info:** Luminaire Luminous Flux see above. CCT 3000K. SDCM 3. CRI >80

**Installation:** Catenary fitting excluding cable and wire. NOTICE new fitting, see drawing.

**Connection:** Terminal block inside housing. Conduit entry.

**Design:** Thomas Bernstrand 2016.

| ART         | DESCRIPTION                   |                               | PRICE/EUR |
|-------------|-------------------------------|-------------------------------|-----------|
| 12081306-30 | CITY catenary D555 black      | IP65 LED 2215LM/26W 3000K     | 1 847,11  |
| 12081306D30 | CITY catenary D555 black      | IP65 LED 2215LM/26W 3000K dim | 1 895,96  |
| 12081366-30 | CITY catenary D555 grey-brown | IP65 LED 2215LM/26W 3000K     | 1 847,11  |
| 12081366D30 | CITY catenary D555 grey-brown | IP65 LED 2215LM/26W 3000K dim | 1 895,96  |

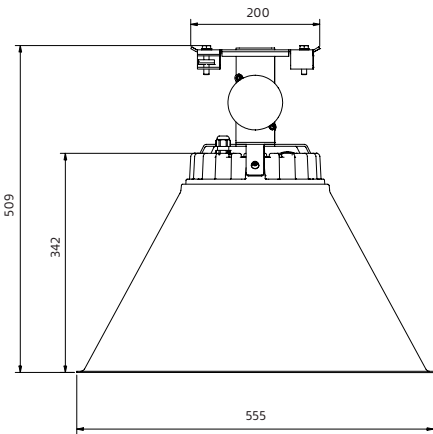

## CITY - Symmetrical



**Finish:** Painted aluminum, black (RAL 9005) or beige grey (RAL 7006) as standard. Other colours on request.  
Internal shade in white painted aluminum. Can be made without grid on request.

**LED info:** Luminaire Luminous Flux see below. CCT 3000K. SDCM 3. CRI >80

**Installation:** On pole D60mm. Pole to be ordered separately.

**Connection:** Cable and quick-plug included when pole mounted.

**Design:** Thomas Bernstrand 2016.

| ART         | DESCRIPTION                  |                               | PRICE/EUR |
|-------------|------------------------------|-------------------------------|-----------|
| 3395306     | CITY post fixture D555 black | IP65 LED 2215LM/26W 3000K     | 2 338,06  |
| 3395306HF-F | CITY post fixture D555 black | IP65 LED 2215LM/26W 3000K Dim | 2 390,67  |
| 3395366     | CITY post D555 greybrown     | IP65 LED 2215LM/26W 3000K     | 2 338,06  |
| 3395366HF-F | CITY post D555 greybrown     | IP65 LED 2215LM/26W 3000K Dim | 2 390,67  |

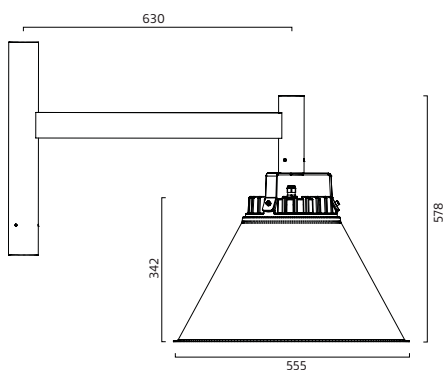

## CITY – Asymmetrical



**Finish:** Painted aluminum, black (RAL 9005) or beige grey (RAL 7006) as standard. Other colours on request.

Internal shade in white painted aluminum. Can be made without grid on request.

**LED info:** Luminaire Luminous Flux see below. CCT 3000K. SDCM 3. CRI >80

**Installation:** On pole D60mm.. Pole to be ordered separately.

**Connection:** Cable and quick-plug included when pole mounted.

**Design:** Thomas Bernstrand 2016.

| ART         | DESCRIPTION                  |                               | PRICE/EUR |
|-------------|------------------------------|-------------------------------|-----------|
| 3396306     | CITY pole fixture asym black | IP65 LED/2267LM/28W/3000K     | 2 482,51  |
| 3396306HF-F | CITY pole fixture asym black | IP65 LED/2455LM/28W/3000K Dim | 2 533,85  |
| 3396366     | CITY pole fixture greybrown  | IP65 LED/2267LM/28W/3000K     | 2 026,12  |
| 3396366     | CITY pole fixture greybrown  | IP65 LED/2455LM/28W/3000K     | 2 482,51  |
| 3396366HF-F | CITY pole fixture greybrown  | IP65 LED/2455LM/28W/3000K Dim | 2 533,85  |

HFF = Dimmable DALI. N=Night-time dim.

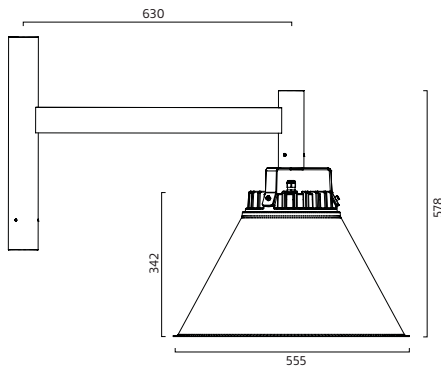

## CITY – Wall



**Finish:** Painted aluminum, black (RAL 9005) or beige grey (RAL 7006) as standard. Other colours on request.

Symmetrical version with internal shade in white painted aluminum. Can be made without grid on request.

**LED info:** Luminaire Luminous Flux see below. CCT 3000K. SDCM 3. CRI >80

**Installation:** On wall.

**Connection:** Junction box in the wall bracekt..

**Design:** Thomas Bernstrand 2016.

| ART                       | DESCRIPTION                   |                               | PRICE/EUR |
|---------------------------|-------------------------------|-------------------------------|-----------|
| <b>Symmetrical light</b>  |                               |                               |           |
| 3398306                   | CITY wall fixture D555 black  | IP65 LED/2215LM/26W/3000K     | 2 351,55  |
| 3398306HF-F               | CITY wall fixture D555 black  | IP65 LED/2215LM/26W/3000K Dim | 2 404,70  |
| 3398366                   | CITY wall D555 greybrown      | IP65 LED/2215LM/26W/3000K     | 2 351,55  |
| 3398366HF-F               | CITY wall D555 greybrown      | IP65 LED/2215LM/26W/3000K Dim | 2 404,70  |
| <b>Asymmetrical light</b> |                               |                               |           |
| 3399306                   | CITY wall fixture D555 black  | IP65 LED/2267LM/32W/3000K     | 2 438,52  |
| 3399306HF-F               | CITY wall fixture D555 black  | IP65 LED/2455LM/28W/3000K Dim | 2 491,67  |
| 3399366                   | CITY wall D555 greybrown asym | IP65 LED/2455LM/28W/3000K     | 2 438,52  |
| 3399366HF-F               | CITY wall D555 greybrown asym | IP65 LED/2455LM/28W/3000K Dim | 2 491,67  |

HFF = Dimmable DALI. N=Night-time dim.

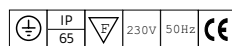
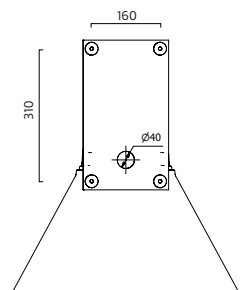
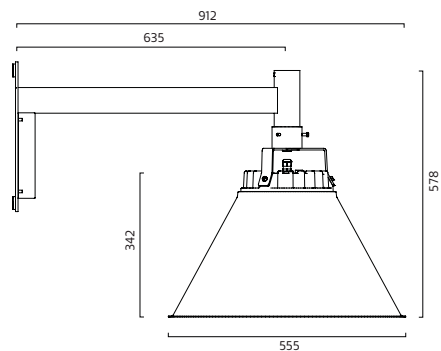

# CITY GLOBE

**Finish:** Painted aluminum and metal, black RAL 9005. Shade in greytoned polycarbonate. Internal shade in opal glass or crackled glass in cognac, red or grey. Other colours on request.

**LED info:** System power 32W. Luminaire Luminous Flux 1420LM, 1900LM. CCT 3000K. SDCM 3. CRI >80

**Installation:** On pole D60 mm.

**Connection:** Cable and quick-plug included when pole mounted

**Design:** Thomas Bernstrand 2019.



| ART         | DESCRIPTION                                |                                | PRICE/EURO |
|-------------|--------------------------------------------|--------------------------------|------------|
| 12000306-30 | CITY Globe polefixture black / opal glass  | IP65 LED/1420LM/26W/3000K      | 2 899,21   |
| 12000306D30 | CITY Globe polefixture black / opal glass  | IP65 LED/1420LM/26W/3000K dim  | 2 951,93   |
| 12000306N30 | CITY Globe polefixture black / opal glass  | IP65 LED/1420LM/26W/3000K natt | 2 951,93   |
| 12001306-30 | CITY Globe polefixture black/ grey glass   | IP65 LED/1900LM/26W/3000K      | 2 899,21   |
| 12001306D30 | CITY Globe polefixture black/ grey glass   | IP65 LED/1900LM/26W/3000K dim  | 2 951,93   |
| 12002306-30 | CITY Globe polefixture black/ cognac glass | IP65 LED/1900LM/26W/3000K      | 2 899,21   |
| 12002306D30 | CITY Globe polefixture black/ cognac glass | IP65 LED/1900LM/26W/3000K dim  | 2 951,93   |
| 12003306-30 | CITY Globe polefixture black/ red glass    | IP65 LED/1900LM/26W/3000K      | 2 899,21   |
| 12003306D30 | CITY Globe polefixture black/ red glass    | IP65 LED/1900LM/26W/3000K dim  | 2 951,93   |

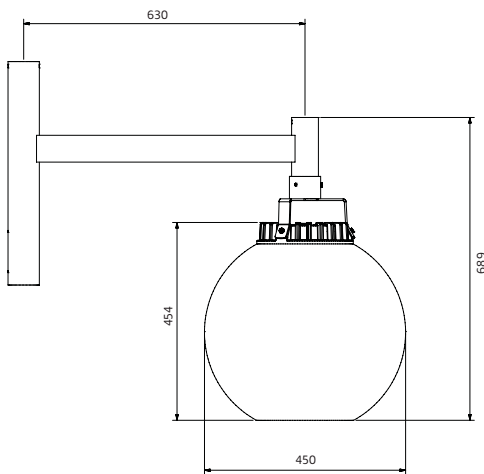

## CITY GLOBE



**Finish** Painted aluminum and metal. Black RAL 9005. Other colors on request. Outer shade in greytoned polycarbonate. Inner shade in cracked glass or open opalglass.

**Led info** System power 32W. Luminaire Luminous Flux 1420LM, 1900LM. CCT 3000K. SDCM 3. CRI >80. L80, 80.000h.

**Installation** On wire, 3-6 mm. *NOTICE new fitting, see drawing.*

**Connection** Terminal block 5x4mm<sup>2</sup> inside housing.

**Design**

Thomas Bernstrand 2019.

| ART         | DESCRIPTION                        |                               | PRICE/EURO |
|-------------|------------------------------------|-------------------------------|------------|
| 12060306-30 | CITY globe wire black opal glass   | IP65 LED/1420LM/26W/3000K     | 2 302,15   |
| 12060306D30 | CITY globe wire black opal glass   | IP65 LED/1420LM/26W/3000K dim | 2 351,00   |
| 12061306-30 | CITY globe wire black grey glass   | IP65 LED/1900LM/26W/3000K     | 2 302,15   |
| 12061306D30 | CITY globe wire black grey glass   | IP65 LED/1900LM/26W/3000K dim | 2 351,00   |
| 12062306-30 | CITY globe wire black cognac glass | IP65 LED/1900LM/26W/3000K     | 2 302,15   |
| 12062306D30 | CITY globe wire black cognac glass | IP65 LED/1900LM/26W/3000K dim | 2 351,00   |
| 12063306-30 | CITY globe wire black red glass    | IP65 LED/1900LM/26W/3000K     | 2 302,15   |
| 12063306D30 | CITY globe wire black red glass    | IP65 LED/1900LM/26W/3000K dim | 2 351,00   |

D = Dimmable DALI. N = Night time dim.

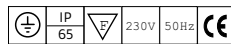
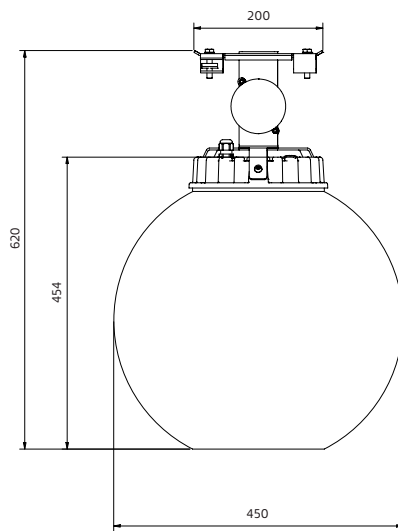



# CITY GLOBE



**Finish** Painted aluminum and metal. Black RAL 9005. Other colors on request. Outer shade in greytoned polycarbonate. Inner shade in crackled glass or open opalglass.

**Led info** System power 32W. Luminaire Luminous Flux 1420LM, 1900LM. CCT 3000K. SDCM 3. CRI >80. L80, 80.000h.

**Installation** On wall.

**Connection** Terminal block 5x4mm<sup>2</sup> inside housing.

**Design**

Thomas Bernstrand 2019.

| ART         | DESCRIPTION                        |                               | PRICE/EURO |
|-------------|------------------------------------|-------------------------------|------------|
| 12005306-30 | CITY Globe wall black/opalglass    | IP65 LED/1420LM/26W/3000K     | 2 777,01   |
| 12005306D30 | CITY Globe wall black/opalglass    | IP65 LED/1420LM/26W/3000K dim | 2 825,86   |
| 12006306-30 | CITY Globe wall black/grey glass   | IP65 LED/1900LM/26W/3000K     | 2 777,01   |
| 12006306D30 | CITY Globe wall black/grey glass   | IP65 LED/1900LM/26W/3000K dim | 2 825,86   |
| 12007306-30 | CITY Globe wall black/cognac glass | IP65 LED/1900LM/26W/3000K     | 2 777,01   |
| 12007306D30 | CITY Globe wall black/cognac glass | IP65 LED/1900LM/26W/3000K dim | 2 825,86   |
| 12008306-30 | CITY Globe wall black/red glass    | IP65 LED/1900LM/26W/3000K     | 2 777,01   |
| 12008306D30 | CITY Globe wall black/red glass    | IP65 LED/1900LM/26W/3000K dim | 2 825,86   |

D = Dimmable DALI. N = Night time dim.

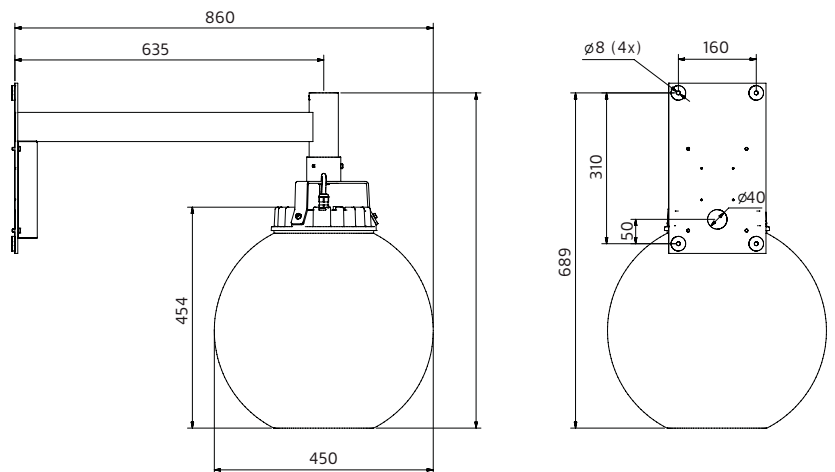

## COLONN



**Finish:** Grey or black painted aluminium. Shade in polycarbonat. Upper shade available as accessory.

**Installation:** On standard pole diameter 60 mm 3-4 m above ground.

**Connection:** Terminal block 4x10mm<sup>2</sup>.

**Design:** Per Sundstedt.

**With patented dynamical reflector. Patent no. 9902727-8**

Including Philips True Force LED light source.

| ART         | DESCRIPTION                    |                    | PRICE/EUR |
|-------------|--------------------------------|--------------------|-----------|
| 3388106-30  | COLONN post fixture black      | IP44 LED 28W/3000K | 1 448,01  |
| 3388110-30  | COLONN post fixture grey       | IP44 LED 28W/3000K | 1 448,01  |
| ACCESSORIES |                                |                    |           |
| 93257106    | COLONN symmetrical shade black |                    | 859,08    |
| 93257110    | COLONN symmetrical shade grey  |                    | 859,08    |

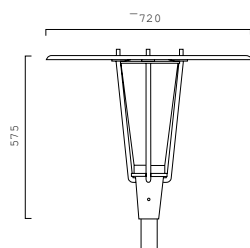
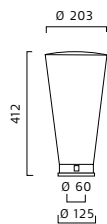

## CONVEX



**Finish:** Painted steel. or galvanized steel. Matt tempered glass.

**Installation:** On wall.

**Connection:** Terminal block 3x4mm<sup>2</sup>. When HFF 5x4mm<sup>2</sup>.

**Design:** Jens Fager 2014.

| ART     | DESCRIPTION               |                   | PRICE/EUR |
|---------|---------------------------|-------------------|-----------|
| 8290101 | CONVEX wall/outdoor white | IP44 LED 505LM/9W | 704,74    |
| 8290106 | CONVEX wall/outdoor black | IP44 LED 505LM/9W | 704,74    |
| 8290183 | CONVEX wall/outdoor galv  | IP44 LED 505LM/9W | 764,97    |
| 8292101 | CONVEX wall/outdoor white | IP44 GU10 max 35W | 562,87    |
| 8292106 | CONVEX wall/outdoor black | IP44 GU10 max 35W | 562,87    |
| 8292183 | CONVEX wall/outdoor galv  | IP44 GU10 max 35W | 577,90    |

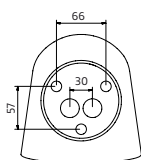
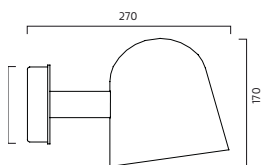

# CONVEX

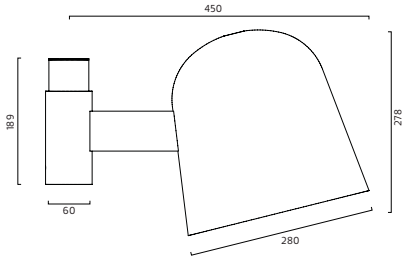

**Finish:** Painted black (RAL 9005), silvergrey (RAL9006) or galvanized metal. Tempered glass. Symmetrical or asymmetrical light beam.

**LED info:** Led see above. CCT 3000K. SDCM 3. CRI >80

**Installation:** On pole top D60mm.

**Connection:** Cable with quick connection inside the pole.

**Design:** Jens Fager 2016.

| ART                        | DESCRIPTION               |                               | PRICE/EUR |
|----------------------------|---------------------------|-------------------------------|-----------|
| <b>Symmetrical comfort</b> |                           |                               |           |
| 8295106                    | CONVEX pole fixture black | IP44 LED/1920LM/35W/3000K     | 1 507,92  |
| 8295106hf-f                | CONVEX pole fixture black | IP44 LED/1920LM/35W/3000K dim | 1 559,37  |
| 8295110                    | CONVEX pole fixture grey  | IP44 LED/1920LM/35W/3000K     | 1 507,92  |
| 8295110hf-f                | CONVEX pole fixture grey  | IP44 LED/1920LM/35W/3000K dim | 1 559,37  |
| 8295183                    | CONVEX pole fixture galv  | IP44 LED/1920LM/35W/3000K     | 1 449,48  |
| 8295183hf-f                | CONVEX pole fixture galv  | IP44 LED/1920LM/35W/3000K dim | 1 500,92  |

## Asymmetrical

|             |                                |                                |          |
|-------------|--------------------------------|--------------------------------|----------|
| 8294106     | CONVEX post fixture black      | IP44 LED/1940LM/32W/3000K asym | 1 553,14 |
| 8294106HF-F | CONVEX post fixture black asym | IP44 LED/1940LM/32W/3000K Dim  | 1 606,11 |
| 8294110     | CONVEX post fixture grey       | IP44 LED/1940LM/32W/3000K asym | 1 553,14 |
| 8294110HF-F | CONVEX post fixture grey asym  | IP44 LED/1940LM/32W/3000K Dim  | 1 606,11 |
| 8294183     | CONVEX post fixture galv       | IP44 LED/1940LM/32W/3000K asym | 1 492,89 |
| 8294183HF-F | CONVEX post fixture galv asym  | IP44 LED/1940LM/32W/3000K Dim  | 1 545,88 |

HFF = Dimmable DALI.

N = Night-time dim.

# CONVEX

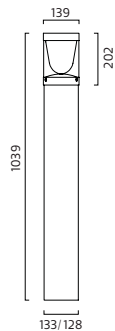

**Finish:** Painted aluminum and metal. Black (RAL9005), silvergrey (RAL 9006) or galvanized metal. Matt and transparent acrylic.

**LED info:** Luminaire Luminous Flux 308LM. 4W. 230V. CCT 3000K. SDCM 3. CRI >80

**Installation:** Fits standard foundations 108 mm or above ground with accessory 93415-1-06.

**Connection:** Terminal block 5x10mm<sup>2</sup>.

**Design:** Jens Fager 2016.

| ART     | DESCRIPTION                    |                         | PRICE/EUR |
|---------|--------------------------------|-------------------------|-----------|
| 3415106 | CONVEX bollard H1039 mm black  | IP44 LED/370LM/6W/3000K | 1 890,41  |
| 3415110 | CONVEX bollard H1039 mm grey   | IP44 LED/370LM/6W/3000K | 1 996,83  |
| 3415147 | CONVEX bollard H1039 mm Corten | IP44 LED/370LM/6W/3000K | 1 939,72  |
| 3415183 | CONVEX bollard H1039 mm galv   | IP44 LED/370LM/6W/3000K | 1 854,46  |

## ACCESSORY

|          |                          |                               |        |
|----------|--------------------------|-------------------------------|--------|
| 93415106 | CONVEX ground base black | for installation above ground | 390,96 |
| 93415110 | CONVEX ground base grey  | for installation above ground | 390,96 |
| 93415147 | CONVEX ground base black | for installation above ground | 390,96 |

## DROPEN

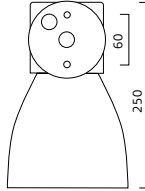
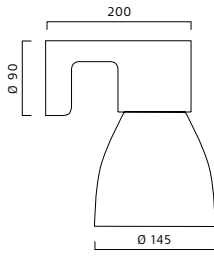

**Finish:** Diecasted aluminium. Shade in clear glass or matt opal glass.

**Installation:** On wall.

**Connection:** Terminal block 3x4mm<sup>2</sup>. Distance-piece for external mains cable available as accessory.

**Design:** Thomas Sandell.

| ART       | DESCRIPTION                  |                          | PRICE/EUR |
|-----------|------------------------------|--------------------------|-----------|
| 4120185   | DROPPEN outdoor fixture      | IP23 75W/E27 clear glass | 442,05    |
| 4220185   | DROPPEN outdoor fixture      | IP23 75W/E27 opalglass   | 442,05    |
| ACCESSORY |                              |                          |           |
| 94140185  | DROPPEN/FELIX distance-piece | for external mains cable | 43,80     |

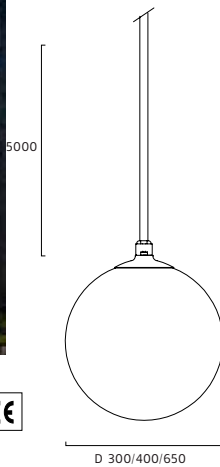

**Finish:** Shade in opal UV-stable polyethene. Handmade net in white or orange. Other colors on request.

**Connection:** 5 m black rubber cable with plug.

**Design:** Mattias Ståhlborn 2011.

| ART     | DESCRIPTION                   |                  | PRICE/EUR |
|---------|-------------------------------|------------------|-----------|
| 3186001 | FISHERMAN pendant opal/white  | IP44 E27 D300 mm | 1 110,50  |
| 3186041 | FISHERMAN pendant opal/orange | IP44 E27 D300 mm | 1 110,50  |
| 3186051 | FISHERMAN pendant opal/blue   | IP44 E27 D300 mm | 1 110,50  |
| 3186101 | FISHERMAN pendant opal/white  | IP44 E27 D400 mm | 1 151,65  |
| 3186141 | FISHERMAN pendant opal/orange | IP44 E27 D400 mm | 1 151,65  |
| 3186151 | FISHERMAN pendant opal/blue   | IP44 E27 D400 mm | 1 151,65  |
| 3186301 | FISHERMAN pendant opal/white  | IP44 E27 D650 mm | 2 179,78  |
| 3186341 | FISHERMAN pendant opal/orange | IP44 E27 D650 mm | 2 179,78  |
| 3186351 | FISHERMAN pendant opal/blue   | IP44 E27 D650 mm | 2 179,78  |

## LUMO CATENARY IP65



**Finish** Painted die-cast aluminum in black RAL 9005. Other colours on request. Microprismatic diffuser. Delivered excluding cable and wire.

**LED info** System power: 22W. Luminaire Luminous Flux: 1690LM. CCT 3000K. SDCM 3. CRI 90. L70/55000H.

**Installation** On wire, 3-6 mm.

**Connection** Terminalblock 3x4 mm<sup>2</sup>. When DALI 5x4mm<sup>2</sup>. Double conduit entry.

**Design** Thomas Bernstrand 2023.

| ART         | DESCRIPTION                             |                                  | PRIS/EUR |
|-------------|-----------------------------------------|----------------------------------|----------|
| 12138106-30 | LUMO wirefitting D250 black             | IP65 LED/22W/1690LM/3000K        | 955,77   |
| 12138106D30 | LUMO wirefitting D250 black<br>D = DALI | IP65 LED/22W/1690LM/3000K DALI 1 | 1 126,56 |

## LUMO WALL IP65



**Finish** Painted die-cast aluminum in black RAL 9005. Other colours on request. Diffuser in matt acrylic. Can be ordered with diffuser in microprisma.

Textile cable in matching colour

**LED info** System power: 10W. Luminaire Luminous Flux: 830LM. CCT 3000K. SDCM 3. CRI 90. L70/55000H.

**Installation** On wall.

**Connection** Terminalblock 3x4 mm<sup>2</sup>. When DALI 5x4mm<sup>2</sup>.

**Design** Thomas Bernstrand 2023.

| ART         | DESCRIPTION                      |                               | PRIS/EUR |
|-------------|----------------------------------|-------------------------------|----------|
| 12140106-30 | LUMO wall D250 black             | IP65 LED/10W/830LM/3000K      | 861,37   |
| 12140106D30 | LUMO wall D250 black<br>D = DALI | IP65 LED/10W/830LM/3000K DALI | 984,42   |

# PATHFINDER



**Finish:** Painted casted aluminum. Black NCS S 9000N or corten finish.  
Diffuser in microprisma.

**LED info:** System power 14W. Luminaire luminous flux 865LM.  
CCT 3000K. SDCM 3. CRI 80. L80 B50 50.000h.

**Installation:** On wall or ceiling.

**Connection:** On/off model possible with double conduit entry- Terminal block 3x2,5mm<sup>2</sup>. Dimmable ceilingmodel: Terminal block 5x2,5mm<sup>2</sup>. Double conduit entry not possible.

**Design:** Kauppi & Kauppi 2019.

| ART         | DESCRIPTION               |                              | PRICE/EURO |
|-------------|---------------------------|------------------------------|------------|
| 13000106-30 | Pathfinder ceiling black  | IP65 LED/14W/865LM/3000K     | 639,93     |
| 13000106D30 | Pathfinder ceiling black  | IP65 LED/14W/865LM/3000K dim | 672,27     |
| 13000147-30 | Pathfinder ceiling Corten | IP65 LED/14W/865LM/3000K     | 704,70     |
| 13000147D30 | Pathfinder ceiling Corten | IP65 LED/14W/865LM/3000K dim | 717,10     |
| 13002106-30 | Pathfinder wall black     | IP65 LED/14W/865LM/3000K     | 815,80     |
| 13002106D30 | Pathfinder wall black     | IP65 LED/14W/865LM/3000K dim | 848,13     |
| 13002147-30 | Pathfinder wall Corten    | IP65 LED/14W/865LM/3000K     | 923,16     |
| 13002147D30 | Pathfinder wall Corten    | IP65 LED/14W/865LM/3000K dim | 955,86     |

D = Dimmable DALI.

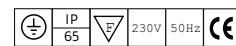
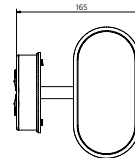
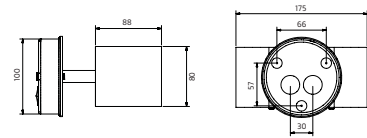
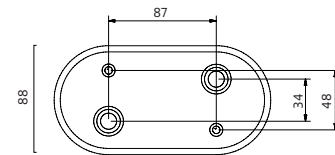
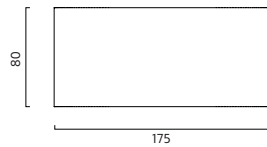

# PATHFINDER



**Finish:** Painted casted aluminum. Black NCS S 9000N or corten finish.

Diffuser in microprisma. Symmetrical or asymmetrical.

It's possible to mount up to 3 extra luminaire heads.

**LED info:** System power 10W. Luminaire luminous flux 430LM, 480LM.

CCT 3000K. SDCM 3. CRI 80. L70 B10 50.000h.

**Installation:** In buried foundation D 76 mm or with ground plate for surface mounting.

**Connection:** Terminal block 4 x 10mm.

**Design:** Kauppi & Kauppi 2019.

| ART                                       | DESCRIPTION                        | PRICE/EURO                             |
|-------------------------------------------|------------------------------------|----------------------------------------|
| <b>For buried foundation installation</b> |                                    |                                        |
| 13005106-30                               | Pathfinder bollard singel black    | IP65/LED/10W/430LM/3000K sym 1 471,08  |
| 13005147-30                               | Pathfinder bollard singel corten   | IP65/LED/10W/430LM/3000K sym 1 514,04  |
| 13006106-30                               | Pathfinder bollard singel black    | IP65/LED/10W/480LM/3000K asym 1 471,08 |
| 13006147-30                               | Pathfinder bollard singel corten   | IP65/LED/10W/480LM/3000K asym 1 514,04 |
| <b>For surface mounting</b>               |                                    |                                        |
| 13007106-30                               | Pathfinder bollard singel black    | IP65/LED/10W/430LM/3000K sym 1 522,56  |
| 13007147-30                               | Pathfinder bollard singel Corten   | IP65/LED/10W/430LM/3000K sym 1 565,51  |
| 13008106-30                               | Pathfinder bollard singel black    | IP65/LED/10W/480LM/3000K asym 1 522,56 |
| 13008147-30                               | Pathfinder bollard singel corten   | IP65/LED/10W/480LM/3000K asym 1 565,51 |
| <b>Extra luminaire head</b>               |                                    |                                        |
| 13009106-30                               | Pathfinder extra lighthouse black  | IP65/LED/10W/430LM/3000K sym 862,63    |
| 13009147-30                               | Pathfinder extra lighthouse corten | IP65/LED/10W/430LM/3000K sym 903,99    |
| 13010106-30                               | Pathfinder extra lighthouse black  | IP65/LED/10W/480LM/3000K asym 862,63   |
| 13010147-30                               | Pathfinder extra lighthouse corten | IP65/LED/10W/480LM/3000K asym 903,99   |
| <b>Extra head with socket type F</b>      |                                    |                                        |
| 13011106                                  | Pathfinder extra lighthouse black  | With socket type F. Excl light 821,45  |
| 13011147                                  | Pathfinder extra lighthouse corten | With socket type F. Excl light 821,45  |

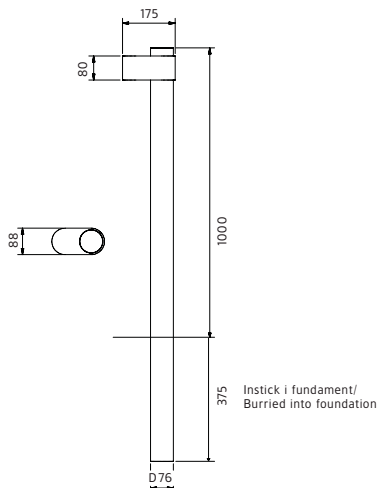

Pollare enkel till fundament/  
Bollard single for ground installation

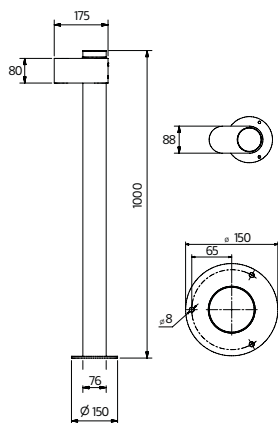

Pollare enkel för ytmontage/  
Bollard single for surface mounting

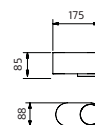

Extra armaturhuvud/  
Extra luminaire head

# PLANT

**Finish:** Bollard with shade in aluminum and tube in stainless steel. Painted grey RAL 9006 or black RAL 9005. Other colours on request. IK 10.

**LED info:** Luminaire Luminous Flux 940LMM. System power 11W.

CCT 3000K. SDCM 3. CRI >80.

**Installation:** Fits buried foundation D 108 mm or with installation plate for installation above ground.

**Connection:** Fuse-box/terminal block 5x25mm<sup>2</sup>.

**Design** Thomas Bernstrand 2020.



| ART                                       | DESCRIPTION                                      | PRIS/SEK                                |
|-------------------------------------------|--------------------------------------------------|-----------------------------------------|
| <b>For buried foundation installation</b> |                                                  |                                         |
| 12035106-30                               | PLANT bollard large cyl black                    | IP54/LED/12W/1080LM/3000K 1 417,53      |
| 12035106D30                               | PLANT bollard large cyl. black                   | IP54/LED/12W/1080LM/3000K Dali 1 444,20 |
| 12035147-30                               | PLANT bollard large cyl. Corten                  | IP54/LED/12W/1080LM/3000K 1 519,33      |
| 12035147D30                               | PLANT bollard large cyl. Corten                  | IP54/LED/12W/1080LM/3000K Dali 1 546,57 |
| 12036106-30                               | PLANT bollard round cyl black                    | IP54/LED/12W/1080LM/3000K 1 417,53      |
| 12036106D30                               | PLANT bollard round cyl. black                   | IP54/LED/12W/1080LM/3000K Dali 1 444,20 |
| 12036147-30                               | PLANT bollard round cyl. Corten                  | IP54/LED/12W/1080LM/3000K 1 519,33      |
| 12036147D30                               | PLANT bollard round cyl. Corten                  | IP54/LED/12W/1080LM/3000K Dali 1 546,57 |
| 12037106-30                               | PLANT bollard samll cyl. black                   | IP54/LED/12W/1080LM/3000K 1 417,53      |
| 12037106D30                               | PLANT bollard samll cyl. black                   | IP54/LED/12W/1080LM/3000K Dali 1 444,20 |
| 12037147-30                               | PLANT bollard samll cyl. Corten                  | IP54/LED/12W/1080LM/3000K 1 519,33      |
| 12037147D30                               | PLANT bollard samll cyl. Corten                  | IP54/LED/12W/1080LM/3000K Dali 1 546,57 |
| <b>For surface mounting</b>               |                                                  |                                         |
| 12045106-30                               | PLANT bollard large cyl black surface mounting   | IP54/LED/12W/1080LM/3000K 1 482,53      |
| 12045106D30                               | PLANT bollard large cyl. black surface mounting  | IP54/LED/12W/1080LM/3000K Dali 1 509,78 |
| 12045147-30                               | PLANT bollard large cyl. Corten surface mounting | IP54/LED/12W/1080LM/3000K 1 579,28      |
| 12045147D30                               | PLANT bollard large cyl. Corten surface mounting | IP54/LED/12W/1080LM/3000K Dali 1 606,53 |
| 12046106-30                               | PLANT bollard round cyl black surface mounting   | IP54/LED/12W/1080LM/3000K 1 482,53      |
| 12046106D30                               | PLANT bollard round cyl. black surface mounting  | IP54/LED/12W/1080LM/3000K Dali 1 509,78 |
| 12046147-30                               | PLANT bollard round cyl. Corten surface mounting | IP54/LED/12W/1080LM/3000K 1 579,28      |
| 12046147D30                               | PLANT bollard round cyl. Corten surface mounting | IP54/LED/12W/1080LM/3000K Dali 1 606,53 |
| 12047106-30                               | PLANT bollard small cyl. black surface mounting  | IP54/LED/12W/1080LM/3000K 1 482,53      |
| 12047106D30                               | PLANT bollard small cyl. black surface mounting  | IP54/LED/12W/1080LM/3000K Dali 1 509,78 |
| 12047147-30                               | PLANT bollard small cyl. Corten surface mounting | IP54/LED/12W/940LM/3000K 1 579,28       |
| 12047147D30                               | PLANT bollard small cyl. Corten surface mounting | IP54/LED/12W/1080LM/3000K Dali 1 606,53 |

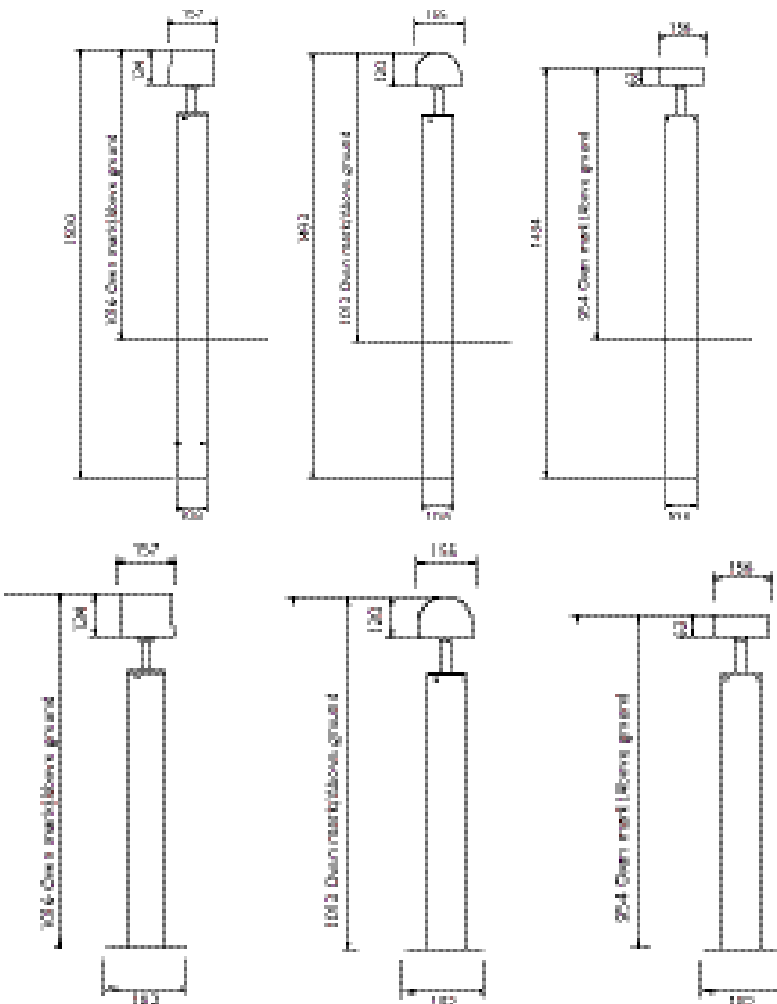



## PLANT WALL



**Finish** Aluminum and metal painted black RAL 9005 or corten finish. Diffuser in tempered glass Other colours on request. IK 7.

**LED info** Luminaire Luminous Flux 822LM. System power 10W. CCT 3000K. SDCM 3. CRI >80. L80 >50.000h.

**Connection** Terminal block 3x4mm<sup>2</sup>.

**Design** Jens Fager 2021.

| ART         | DESCRIPTION                  |                          | PRICE/EUR |
|-------------|------------------------------|--------------------------|-----------|
| 12031106-30 | PLANT wall large cyl. black  | IP44 LED/822LM/10W/3000K | 713,15    |
| 12031106D30 | PLANT wall large cyl. black  | IP44 LED/822LM/10W/3000K | 762,60    |
| 12031147-30 | PLANT wall large cyl. Corten | IP44 LED/822LM/10W/3000K | 771,72    |
| 12031147D30 | PLANT wall large cyl. Corten | IP44 LED/822LM/10W/3000K | 821,18    |
| 12032106-30 | PLANT wall round cyl. Black  | IP44 LED/822LM/10W/3000K | 713,15    |
| 12032106D30 | PLANT wall round cyl. Black  | IP44 LED/822LM/10W/3000K | 762,60    |
| 12032147-30 | PLANT wall round cyl. Corten | IP44 LED/822LM/10W/3000K | 771,72    |
| 12032147D30 | PLANT wall round cyl. Corten | IP44 LED/822LM/10W/3000K | 821,18    |

12031

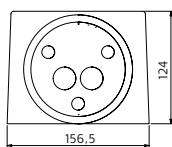
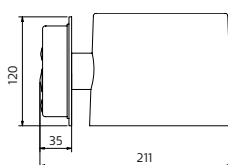

12032

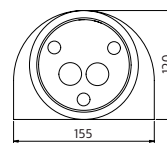
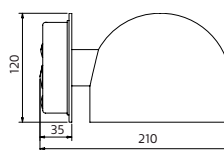

## PUCK

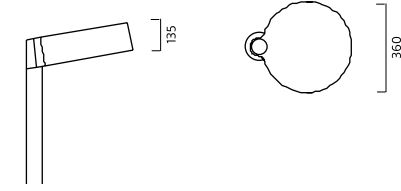

**Finish:** Silver grey painted steel RAL 9006. Reflector in aluminium. Cover of tempered glass.

Coast line model in galvanized steel.

**Installation:** Fits pole diameter 60 mm

**Connection:** Terminal block 4x10mm<sup>2</sup>.

**Design:** R. Aosta.

| ART                 | DESCRIPTION             |                                | PRICE/EUR |
|---------------------|-------------------------|--------------------------------|-----------|
| <b>Symmetrical</b>  |                         |                                |           |
| 3279110             | PUCK pole fixtures grey | IP44 LED 2344LM/32W Symm       | 1 260,78  |
| 3279110HF-F         | PUCK pole fixtures grey | IP44 LED 2344LM/32W Symm Dim   | 1 312,25  |
| 3279183             | PUCK pole fixtures galv | IP44 LED 2344LM/32W Symm       | 1 417,69  |
| 3279183HF-F         | PUCK pole fixtures galv | IP44 LED 2344LM/32W Symm Dim   | 1 468,98  |
| <b>Asymmetrical</b> |                         |                                |           |
| 3380110             | PUCK pole fixtures grey | IP44 LED 2140LM/32W/3000K Asym | 1 260,78  |
| 3380110HF-F         | PUCK pole fixtures grey | IP44 LED 2140LM/32W/3000K Asym | 1 312,25  |
| 3380183             | PUCK pole fixtures galv | IP44 LED 2140LM/32W/3000K Asym | 1 417,69  |
| 3380183HF-F         | PUCK pole fixtures galv | IP44 LED 2140LM/32W/3000K Asym | 1 468,98  |

HFF = Dimmable DALI.  
N = Night-time dim.

## PUCK

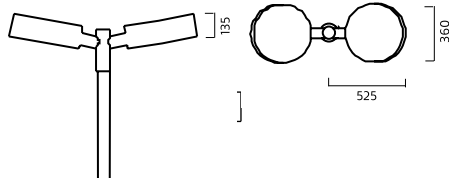

**Finish:** Silver grey painted steel. Reflector in aluminium. Cover of tempered glass. Coast line model in galvanized steel.

**Installation:** Fits pole diameter 60 mm

**Connection:** Terminal block 4x10mm<sup>2</sup>.

**Design:** R. Aosta.

| ART                 | DESCRIPTION                 |                                | PRICE/EUR |
|---------------------|-----------------------------|--------------------------------|-----------|
| <b>Symmetrical</b>  |                             |                                |           |
| 3279210             | TWO PUCK pole fixtures grey | IP44 LED 2344LM/32W Symm       | 2 638,24  |
| 3279210HF-F         | TWO PUCK pole fixtures grey | IP44 LED 2344LM/32W Symm Dim   | 2 740,83  |
| 3279283             | TWO PUCK pole fixtures galv | IP44 LED 2344LM/32W Symm       | 2 964,96  |
| 3279283HF-F         | TWO PUCK pole fixtures galv | IP44 LED 2344LM/32W Symm Dim   | 3 067,88  |
| <b>Asymmetrical</b> |                             |                                |           |
| 3380210             | TWO PUCK pole fixtures grey | IP44 LED 2140LM/32W/3000K Asym | 2 638,24  |
| 3380210HF-F         | TWO PUCK pole fixtures grey | IP44 LED 2140LM/32W/3000K Asym | 2 740,83  |
| 3380283             | TWO PUCK pole fixtures galv | IP44 LED 2140LM/32W/3000K Asym | 2 964,96  |
| 3380283HF-F         | TWO PUCK pole fixtures galv | IP44 LED 2140LM/32W/3000K Asym | 3 067,88  |

HFF = Dimmable DALI.  
N = Night-time dim.

## PUCK

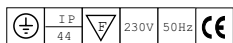
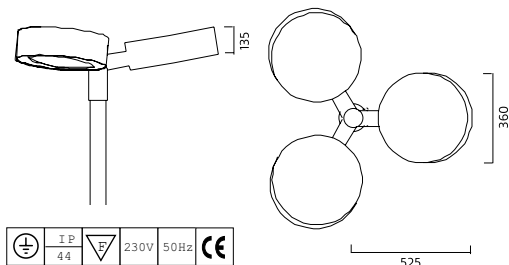

**Finish:** Silver grey painted steel. Reflector in aluminium. Cover of tempered glass. Coast line model in galvanized steel.

**Installation:** Fits pole diameter 60 mm

**Connection:** Terminal block 4x10mm<sup>2</sup>.

**Design:** R. Aosta.

| ART                | DESCRIPTION                   |                              | PRICE/EUR |
|--------------------|-------------------------------|------------------------------|-----------|
| <b>Symmetrical</b> |                               |                              |           |
| 3279310            | THREE PUCK pole fixtures grey | IP44 LED 2344LM/32W Symm     | 3 945,79  |
| 3279310HF-F        | THREE PUCK pole fixtures grey | IP44 LED 2344LM/32W Symm Dim | 4 048,21  |
| 3279383            | THREE PUCK pole fixtures galv | IP44 LED 2344LM/32W Symm     | 4 412,65  |
| 3279383HF-F        | THREE PUCK pole fixtures galv | IP44 LED 2344LM/32W Symm Dim | 4 515,58  |

|                     |                               |                                    |          |
|---------------------|-------------------------------|------------------------------------|----------|
| <b>Asymmetrical</b> |                               |                                    |          |
| 3380310             | THREE PUCK pole fixtures grey | IP44 LED 2140LM/32W/3000K Asym     | 3 945,79 |
| 3380310HF-F         | THREE PUCK pole fixtures grey | IP44 LED 2140LM/32W/3000K Asym Dim | 4 048,21 |
| 3380383             | THREE PUCK pole fixtures galv | IP44 LED 2140LM/32W/3000K Asym     | 4 412,65 |
| 3380383HF-F         | THREE PUCK pole fixtures galv | IP44 LED 2140LM/32W/3000K Asym Dim | 4 515,58 |

HFF = Dimmable DALI.

N = Night-time dim 6 hours.

## PUCK

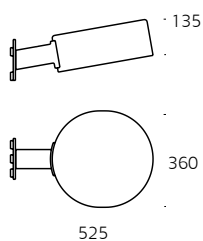

**Finish:** Silver grey painted steel. Reflector in aluminium. Coast line model in galvanized steel. Cover in tempered glass.

**Installation:** On wall.

**Connection:** Terminal block 3x2,5mm<sup>2</sup>. Two entry holes.

| ART                | DESCRIPTION                    |                              | PRICE/EUR |
|--------------------|--------------------------------|------------------------------|-----------|
| <b>Symmetrical</b> |                                |                              |           |
| 3282110            | PUCK outdoor fixture wall grey | IP44 LED 2344LM/32W Symm     | 1 405,45  |
| 3282110HF-F        | PUCK outdoor fixture wall grey | IP44 LED 2344LM/32W Symm Dim | 1 419,36  |
| 3282183            | PUCK outdoor fixture wall galv | IP44 LED 2344LM/32W Symm     | 1 517,60  |
| 3282183HF-F        | PUCK outdoor fixture wall galv | IP44 LED 2344LM/32W Symm Dim | 1 569,06  |

|                     |                                |                               |          |
|---------------------|--------------------------------|-------------------------------|----------|
| <b>Asymmetrical</b> |                                |                               |          |
| 3382110             | PUCK outdoor fixture wall grey | IP44 LED 2140LM/32W Asymm     | 1 354,15 |
| 3382110HF-F         | PUCK outdoor fixture wall grey | IP44 LED 2140LM/32W Asymm Dim | 1 405,45 |
| 3382183             | PUCK outdoor fixture wall galv | IP44 LED 2140LM/32W Asymm     | 1 517,60 |
| 3382183HF-F         | PUCK outdoor fixture wall galv | IP44 LED 2140LM/32W Asymm Dim | 1 569,06 |

LED = Dimmable DALI. N = Night-time dim.

## PXL

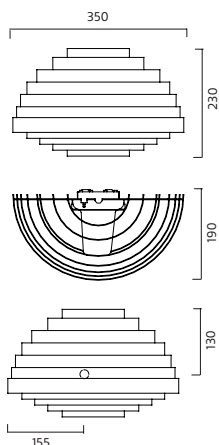

**Finish:** White painted metal or galvanized metal.

**Installation:** On Wall.

**Connection:** Snap-in terminal block 3x4mm<sup>2</sup>.

**Design:** Fredrik Mattson.

| ART     | DESCRIPTION                |                            | PRICE/EUR |
|---------|----------------------------|----------------------------|-----------|
| 7795101 | PXL outdoor fixture white  | IP65 LED 522LM/10W B320 mm | 938,28    |
| 7795147 | PXL outdoor fixture Corten | IP65 LED 522LM/10W B320 mm | 912,70    |
| 7795183 | PXL outdoor fixture galv   | IP65 LED 522LM/10W B320 mm | 1 112,10  |



Zero, Friluftsvagen 2, 382 34 Nybro, Sweden

Tel: +46 (0) 481 800 00

Zero Showroom, Södermalmsallén, Stockholm, Sweden

Tel: +46 (0) 8 545 850 00

info@zero.se www.zero.se

